

01 LOBBY B PLAN (LOBBY C SIMILAR)
SCALE: 1:100



02 LOBBY B - VIEW 01
NTS



03 LOBBY E - VIEW 02 (LOBBY D SIMILAR)
NTS

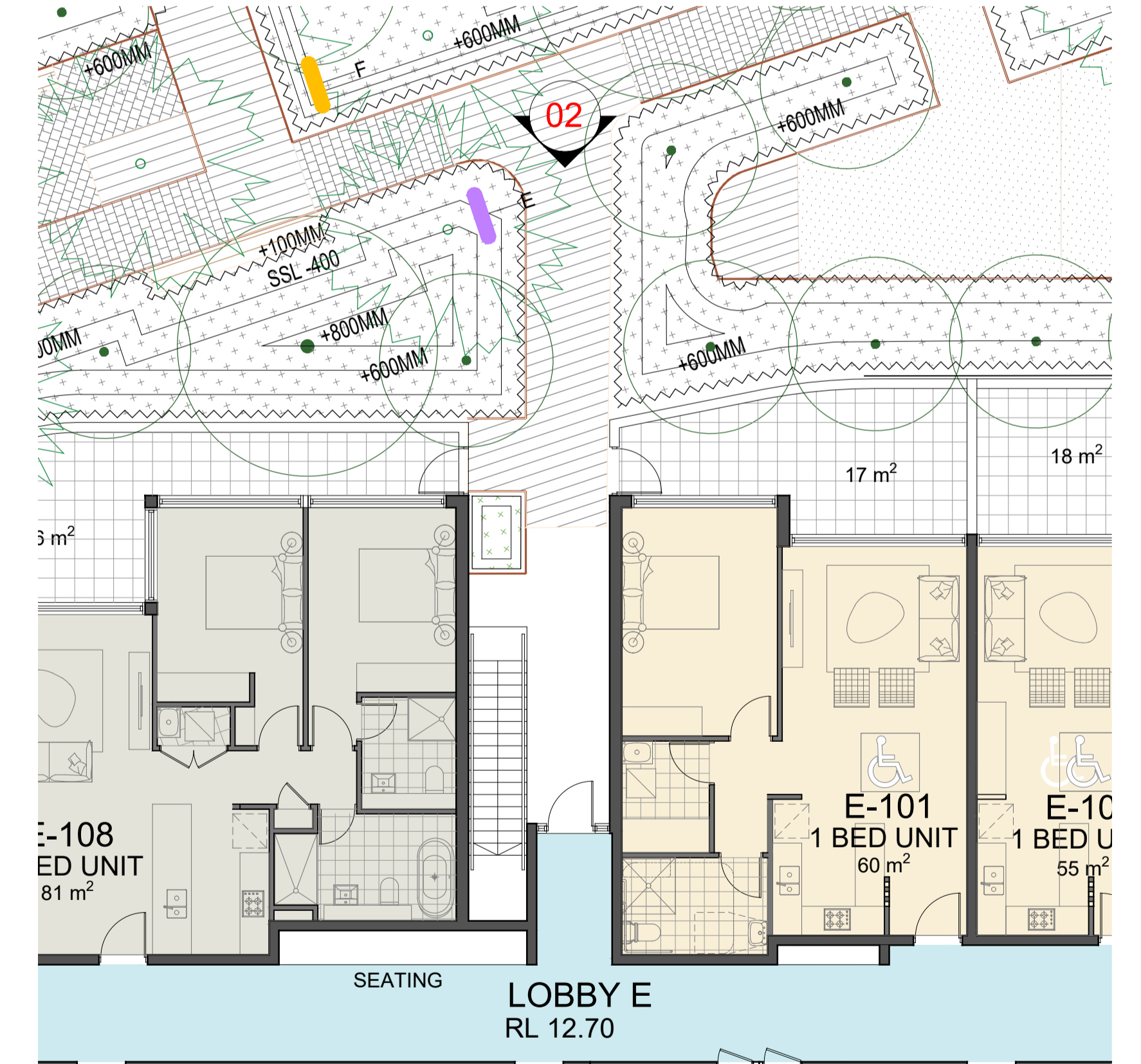

04 LOBBY E PLAN
1:100

True North

Scale: 1:250@A1 1:500@A3

Date Printed:
09/02/2022

ISSUE	REVISION DESCRIPTION	APP'D	DATE
F	Amendments to Building F Including Deleting the Third floor & Typical Units Layout changes on L1 - L2	JA/HE	28/02/2022
E	Re-issue for S34 CONFERENCE	JA/HE	12/11/2021
D	S34 CONFERENCE	JA/HE	26/10/2021
C	ADDITIONAL INFORMATION ISSUE TO COUNCIL AND DRP	JA/MC	26/02/2021
B	ADDITIONAL INFORMATION ISSUE TO COUNCIL AND DRP	JA/MC	28/08/2020
A	ISSUE FOR DA SUBMISSION	JA	28/02/2020

Client:
Thirroul Plaza Pty. Ltd.

Architect:
LOUCAS ARCHITECTS
ABN 92 626 290 122

Level 3, Suite 309, 7-9 Gibbons St.
Redfern NSW, Australia

Tel: (02) 8052 9600
Email: admin@loucasarc.com.au

Nominated Architect:
Jim Apostolou 7490

Project Details:
MIXED USE DEVELOPMENT
ADDRESS:
303-304 & 282-298 Lawrence Hargrave Dr.
THIRROUL, NSW 2192

Drawing Title:
ENTRY LOBBIES

Project Number:
Pn-17002

Drawing Status:
AUTHORITY APPROVAL

Drawing Number:
A-950

Issue:
F

THIS DRAWING SHOULD BE READ IN CONJUNCTION WITH ALL RELEVANT CONTRACTS, SPECIFICATIONS, REPORTS AND DRAWINGS. COPYRIGHT OF THIS DRAWING IS VESTED IN LOUCAS ARCHITECTS