

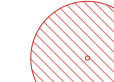

LEGEND:

-  TREES TO BE RETAINED
-  TREES THAT ARE EXEMPT AND REMOVED
-  TREES TO BE REMOVED

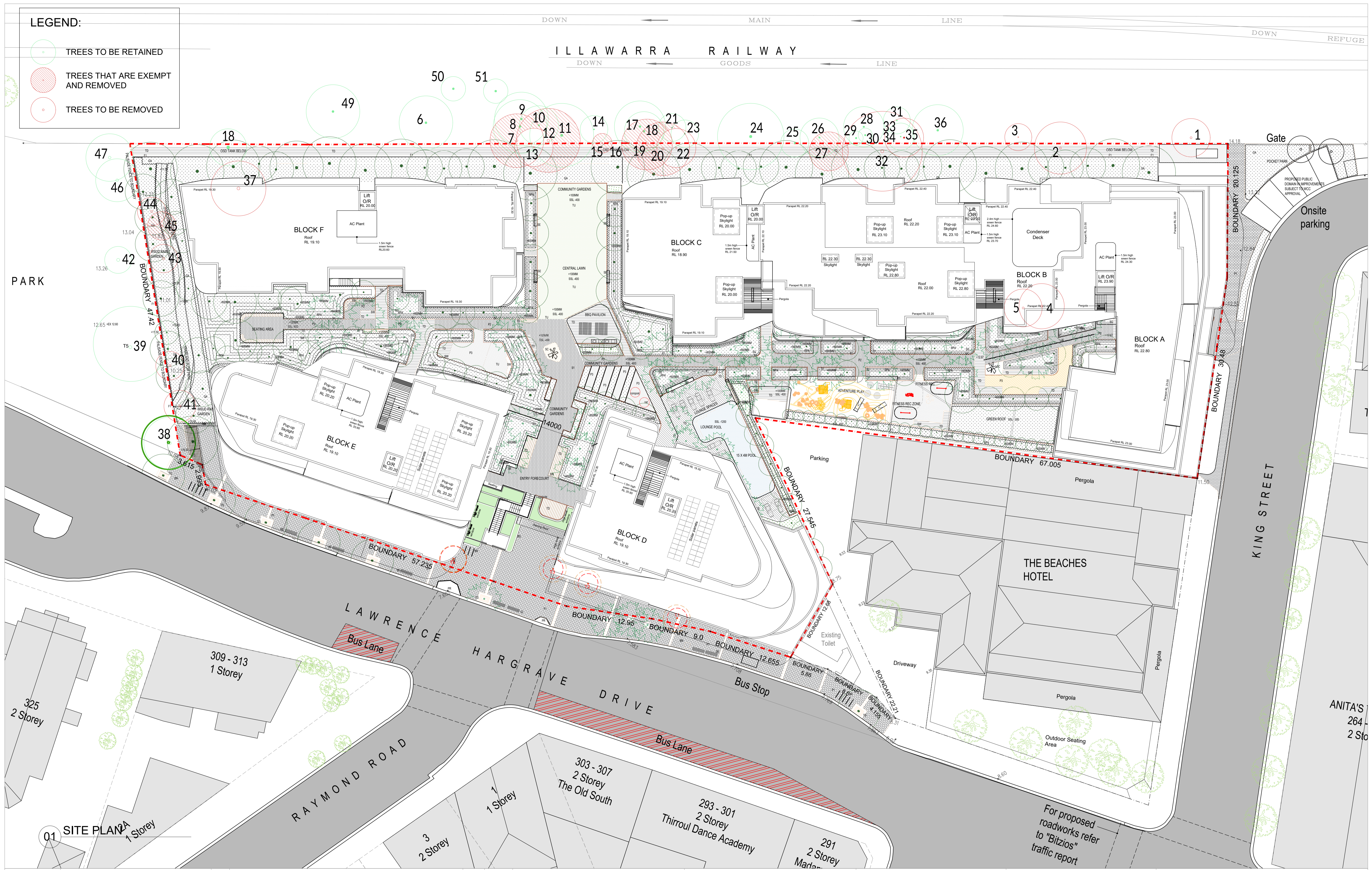

True North

Scale: 1:250@A1 1:500@A3

0 2.5 5 7.5 10 12.5

Date Printed: 09/02/2022

ISSUE	REVISION DESCRIPTION	APP'D	DATE
D	Amendments to Building F Including Deleting the Third floor & Typical Units Layout changes on L1 - L2	JA/HE	28/02/2022
C	ADDITIONAL INFORMATION ISSUE TO COUNCIL AND DRP	JA/MC	26/02/2021
B	ADDITIONAL INFORMATION ISSUE TO COUNCIL AND DRP	JA/MC	28/08/2020
A	ISSUE FOR DA SUBMISSION	JA	28/02/2020

Client: Thirroul Plaza Pty. Ltd.

Architect: LOUCAS ARCHITECTS
 ABN 92 626 290 122
 Level 3, Suite 309, 7-9 Gibbons St, Redfern NSW, Australia
 Tel: (02) 8052 9600
 Email: admin@loucasarc.com.au
 Nominated Architect: Jim Apostolou 7490



Project Details: MIXED USE DEVELOPMENT

ADDRESS: 303-304 & 282-298 Lawrence Hargrave Dr, THIRROUL, NSW 2192

Drawing Title: SITE PLAN

For proposed roadworks refer to "Bizios" traffic report

Project Number: Pn-17002

Drawing Status: AUTHORITY APPROVAL

Drawing Number: A-020

Issue: D

THIS DRAWING SHOULD BE READ IN CONJUNCTION WITH ALL RELEVANT CONTRACTS, SPECIFICATIONS, REPORTS AND DRAWINGS. COPYRIGHT OF THIS DRAWING IS VESTED IN LOUCAS ARCHITECTS